

**OPEN LINESHAFT OVERALL**

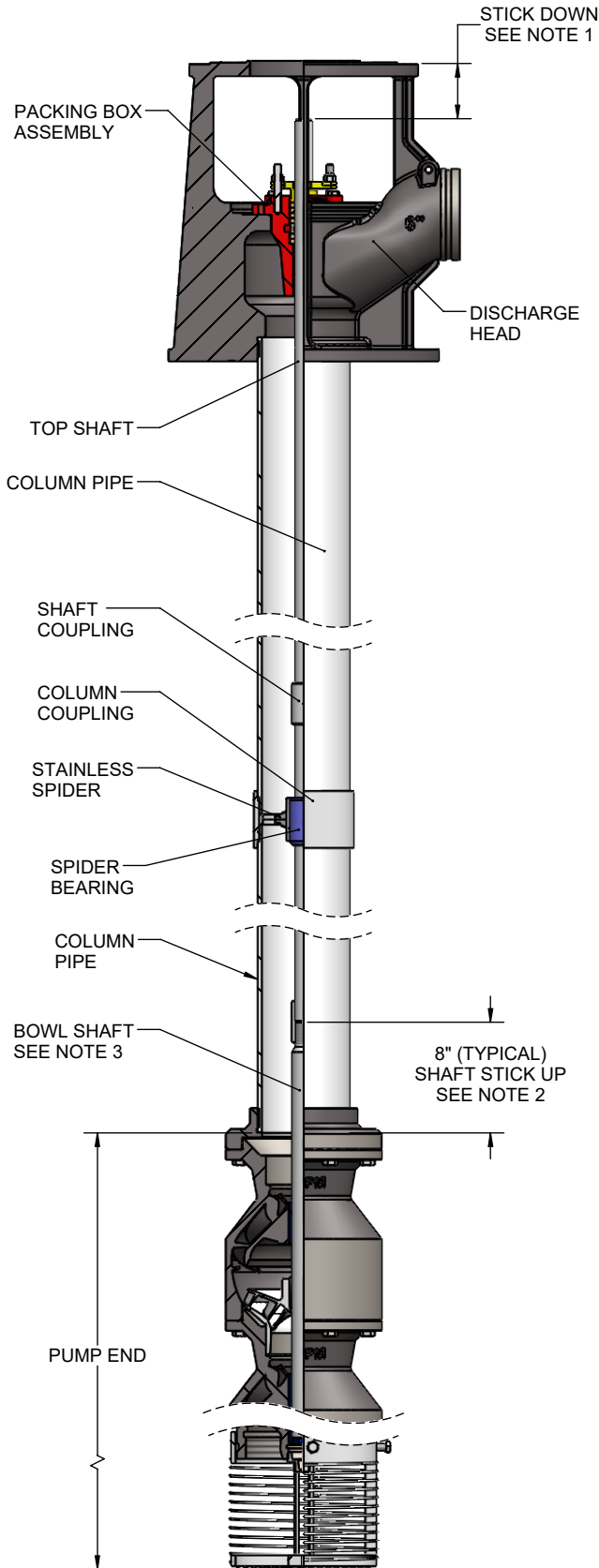

**PACKING BOX ASSEMBLY DETAIL**

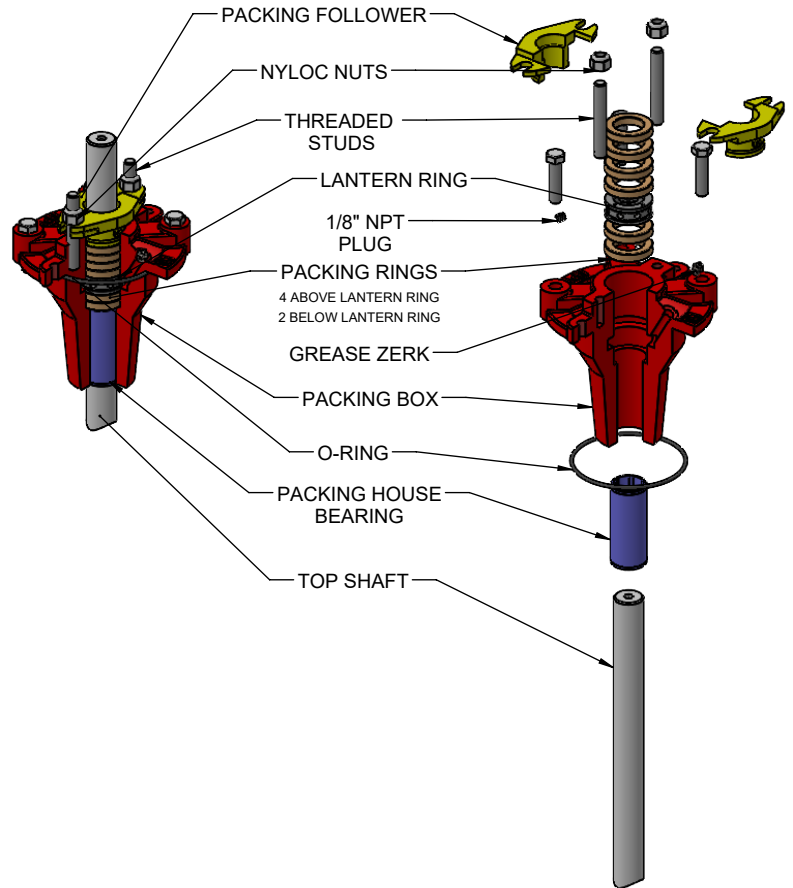

**NOTES:**

1. STICK DOWN IS MEASURED FROM THE TOP OF THE DISCHARGE HEAD TO THE TOP OF THE TOP SHAFT. TYPICALLY 4" WITH INTEGRITY PUMP AND MOTOR
2. MEASURED FROM WHERE THE COLUMN PIPE CONNECTS TO THE PUMP END. TYPICALLY 8" WITH INTEGRITY PUMP AND MOTOR
3. BOWL SHAFT IS TURNED DOWN (IF NEEDED) AT TOP TO MATCH NECESSARY LINE SHAFT.
4. COLORS ARE NOT REPRESENTATIVE OF FINAL PRODUCT



**DESCRIPTION:**  
OPEN LINE SHAFT VERTICAL TURBINE ASSEMBLY BREAKDOWN

<b>DRW BY:</b> JDA	<b>CHK BY:</b> RS	<b>DRW DATE:</b> 07/29/2024	<b>SHEET:</b> 1 OF 1
<b>FORM. No.</b> ENG189			<b>REV</b> -